

Enhanced Survey Program (ESP) Documents



Blank **ESP Documents** are available through the MyFreedom Portal to aid with hull survey preparation for vessels enrolled in the Enhanced Survey Program.

From the Fleet Overview Page, select a Vessel and click "Surveys" from the left menu. The screen will default to 'Scheduled' Surveys.

SCHEDULED

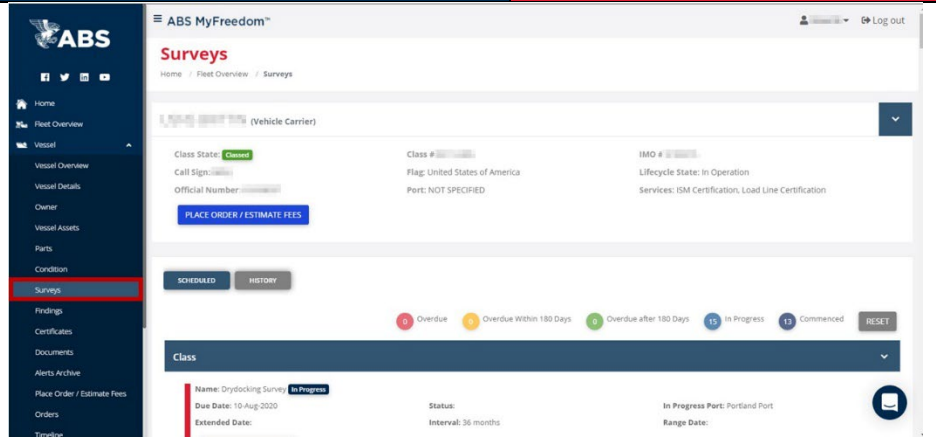

For vessels enrolled in the Enhanced Survey Program, a blank Survey Planning Questionnaire and Survey Program Document are available for applicable Hull Surveys.

When available, they are accessible via the 'ESP/ESDC' Button and will be downloaded as a .ZIP file.

ESP/ESDC

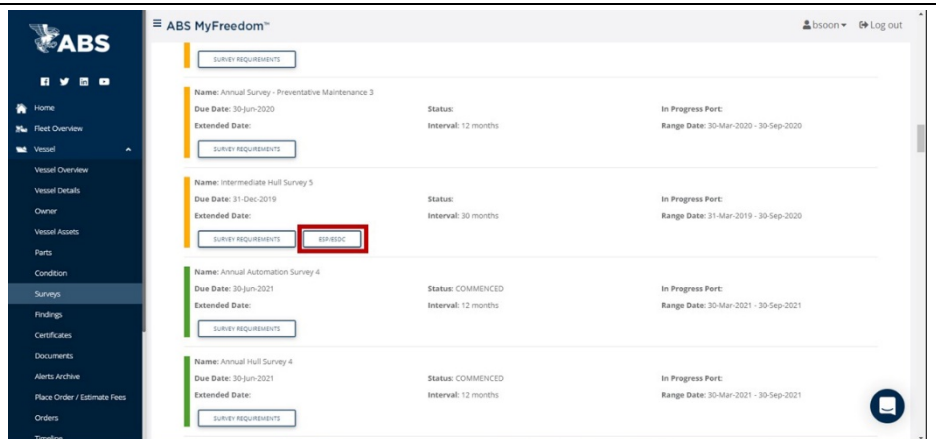

The ESP Survey Planning Questionnaire and Survey Program Document will be available in your 'Downloads' folder.

To open, select the desired file and open by right-clicking on the file name and selecting the appropriate reader program, such as Adobe Acrobat Reader.

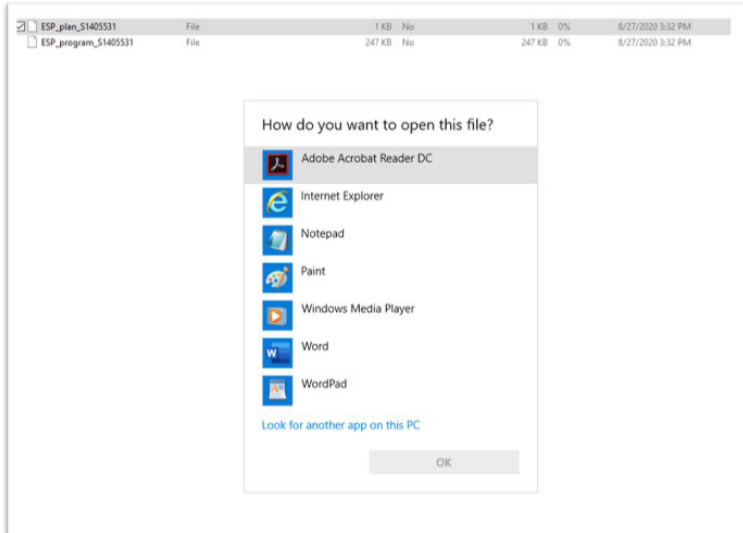

Survey Planning Questionnaire:

The Survey Planning Questionnaire is pre-populated with vessel and survey information.

You may populate any of the editable fields.

Intermediate Hull Survey 5
ESP (Enhanced Survey Program)
Oil Carrier
Double Hull

Survey Planning Questionnaire

CDC TANKER
IMO No.123456789

*A1, Oil Carrier, ESP, testing Restricted Service, Circle E, Circle E with bracketed R, (*JAMS, *ACCU, *IRCC-SP 123/45, *RC S, CSR, AB-CM, SH (S 123), SHCM, Wind IHR

Prepared by: _____ Reviewed by: _____
Owner: _____ ABS Surveyor: _____
Place: _____ Place: _____
Sign: _____ Sign: _____
Date: _____ Date: _____

AMERICAN BUREAU OF SHIPPING 0722221-ESPG-R155
Table of Content

- 1.Vessel Particulars..... 3
- 2.Information on Access Provision for Close-up Surveys and Thickness Measurement..... 4
- 3.Owner's Inspection..... 6
- 4.Report of Port State Control Inspections Safety Management System, Thickness Company..... 10



Survey Program Document:

The Survey Program Document is pre-populated with vessel and survey information.

You may populate any of the editable fields.

Oil Carrier
Double Hull

Survey Program

CDC TANKER
IMO No.123456789

*A1, Oil Carrier, ESP, testing Restricted Service, Circle E, Circle E with bracketed R, (*JAMS, *ACCU, *IRCC-SP 123/45, *RC S, CSR, AB-CM, SH (S 123), SHCM, Wind IHR

Prepared by: _____ Reviewed by: _____
Owner: _____ ABS Surveyor: _____
Place: _____ Place: _____
Sign: _____ Sign: _____
Date: _____ Date: _____

AMERICAN BUREAU OF SHIPPING 0722221-ESPP-R155
Table of Content

- 1. Survey Planning Revision History..... 3
- 2. Basic Information and Vessel Particulars..... 4
- 3. Arrangement with information on the use, extent of coatings, and corrosion prevention systems of cargo hold, tanks and space..... 5
- 4. Condition of survey..... 9
- 5. Provisions and method of access to structures..... 10
- 6. List of the equipments carried out during survey..... 11
- 7-9. Survey Requirements..... 12
- 10. Minimum thickness requirements of the hull structures..... 32
- 11. Thickness Measurement Company..... 32
- 12. Damage reports..... 33
- 13. List of substantial corrosion..... 34
- 14. List of critical structural areas and the suspect areas..... 34
- 15. Any comments and information relevant to the survey..... 34
- 16. Survey plan table..... 36



Note: The original signed copy of this document is maintained by the Owner in the Survey Report File of the vessel

Survey Plan Document:

The Survey plan Document is pre-populated with vessel and survey information.

You may populate any of the editable fields.

AMERICAN BUREAU OF SHIPPING 15255838-ESDCP-SSH1

Special Periodical Survey - Hull 1
ESDC (Expanded Survey Dry Cargo Vessel)

Survey Plan

TEST SHIP 1
IMO No. 1234567
*A1, ESDC, Circle E, *AMS, CPS

Prepared by: _____ Reviewed by: _____
Owner: _____ ABS Surveyor: _____
Place: _____ Place: _____
Sign: _____ Sign: _____
Date: _____ Date: _____

AMERICAN BUREAU OF SHIPPING 15255838-ESDCP-SSH1
Table of Content

- 1. Survey Planning Revision History..... 3
- 2. Vessel Particulars..... 4
- 3. General..... 5
- 4. Close-Up Surveys..... 9
- 5. Thickness Measurements..... 10
- 6. Tank Testing..... 11
- 7. Tank/Hold Particulars..... 13



Note: The original signed copy of this document is maintained by the Owner in the Survey Report File of the vessel

Survey Plan Print Date: Thu Jun 11 10:17:43 CDT 2020 Page 1 of 15

Submitting ESP Documents

The completed ESP Documents can be submitted to ABS when requesting the associated hull survey via the MyFreedom Portal. The completed document can be uploaded as an attachment on the Place Order Page.

The ESP documents will then be available in the ABS Work Order for the attending Surveyor.

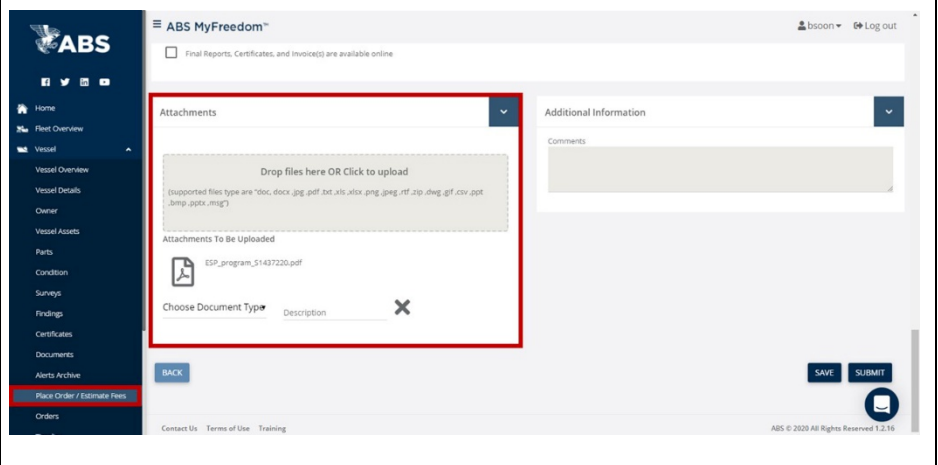

Viewing updated ESP Documents

ESP/ESDC documents updated during an attendance are accessible from Documents under Vessel in the left-hand menu.

